



File Name: Cuisinart cb-600 manual.pdf

Size: 2600 KB

Type: PDF, ePub, eBook

Category: Book

Uploaded: 5 May 2019, 20:12 PM

Rating: 4.6/5 from 702 votes.

Download Now!

Please check the box below to proceed.



I'm not a robot



reCAPTCHA
Privacy - Terms

Book Descriptions:

Cuisinart cb-600 manual



I stored my instruction manual and owners manual in my Jack LaLanne Health Master 100 and hit pulse by mistake. How can i get a replacement manual and. How can we getr another manual. I just got this blender but in packing to ship it my cousin forgot to put the manual how can I see it is about blenders, so check here Download Free Manual s, maybe youll find what youre looking for. If you dont find anything, please let us know which. Any information as to where I can locate a manual. I just had the same problem, did a little research on the internet. Amount of liquid and ice. Cant find my manual and having a party tomorrow. Here is a link to the newest blender manual. I assume the measurements will be the same.. Answer questions, earn points and help others. To calculate the overall star rating and percentage breakdown by star, we don't use a simple average. Instead, our system considers things like how recent a review is and if the reviewer bought the item on Amazon. It also analyzes reviews to verify trustworthiness. See All Buying Options Add to Wish List Disabling it will result in some disabled or missing features. You can still see all customer reviews for the product. It is so powerful, I have ground wheat with it and it completely purees solidly frozen strawberries. I have another blender that I got at the same time and I only keep it around as a backup, it doesnt hold a candle to the Cuisinart. I agree that it is loud and the pour spout is not great

which is why it got 4 stars instead of 5. Reviewed in the United States on December 16, 2012 I have had a terrible experience with this blender. Its loud, it leaks, the handle broke off and frankly it doesnt work very well. I use a blender about every day and am totally frustrated with this thing every time I use it. The worst part is that cuisinart could care

less.<http://czechdidgeridoo.com/admin/upload/how-to-manual-car-wash.xml>

- cuisinart cb-600 fp manual, cuisinart cb-600 manual, cuisinart cb-600 blender manual, cuisinart cb 600 fp manual.

FEATURES AND BENEFITS

- 1. Reservoir Cover**
Flips back for easy filling.
- 2. Water Reservoir**
- 3. Showerhead (not shown)**
Distributes water evenly over coffee, reducing temperature loss as water passes through grounds.
- 4. Water Filter (not shown)**
Charcoal water filter eliminates chlorine, calcium and bad tastes and odors from tap water.
- 5. Filter Basket (not shown)**
Holds a #4 paper filter or a permanent filter.
- 6. Filter Basket Holder**
- 7. LCD Digital Clock**
Displays time of day and set time for automatic functions.
- 8. Hour and Minute Buttons**
Used to set time of day and automatic functions.
- 9. Function Knob and Flip Switch**
Used to initiate programming of automatic functions.
 - a. Heater Plate Control Knob**
For controlling the temperature of the coffee after brewing. There are three temperature settings.
 - b. 1-4 Cup Setting**
For brewing smaller pots of coffee. It provides 'double' heating of the water, so coffee is piping hot.
 - c. Self-Clean Setting**
Tells you when it's time to clean your coffeemaker. Remove built-up calcification from the water reservoir, to help extend the life of your coffeemaker.
- 10. Brew Pause™**
Stops flow of coffee from basket when carafe is removed (30 seconds max) from the heater plate, so a cup can be poured in mid-brew. Since the extraction rate varies during the brew

cycle, we recommend allowing the brewing cycle to finish before pouring the coffee.

- 11. Ready Tone**
Signals the end of the brew cycle with five beeps.
- 12. Carafe**
The easy pour, no drip carafe has an ergonomic handle and brewed coffee markings for two to twelve cups.
- 13. Heating Plate**
Scratch resistant with black, nonstick coating.

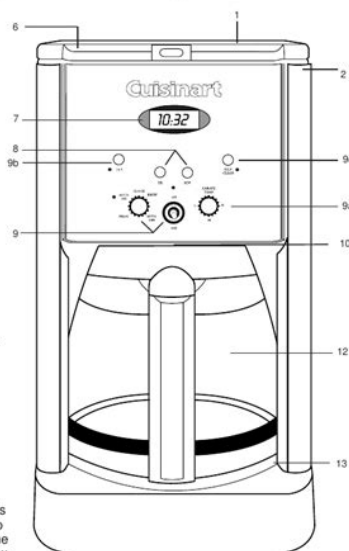

When I contacted them they offered to replace it with an identical, equally sucky machine but required that I pay the shipping and a ten dollar restocking fee, which was ridiculous as the thing broke within the first week of using it. The first one ground off the plastic bearings on the base and the handle broke completely off the second one. Not even going to bother to pay the ten dollar restocking fee for this piece of junk. Please try again later. Shanell 1.0 out of 5 stars Its loud, it leaks, the handle broke off and frankly it doesnt work very well. Not even going to bother to pay the ten dollar restocking fee for this piece of junk. Please try again later. Please try again later. Marri 3.0 out of 5 stars Very hard to find replacement parts That I would say was because of over use and putting too much food in the feed tube by someone else! I kept the blender and used it for a few more years until I dropped the blender jar and broke it. I found it nearly impossible to locate the replacement parts even though I still had the instruction booklet. I dont remember how much I even paid for it but Im pretty sure it isnt worth replacing the blender jar at that price. After reading the reviews that said it was loud I did remember that it was unusually loud even for a blender. I think I would have brought it again though since its hard to find good quality blenders that last that long and it was a food processor although a smaller one with a blender for the price of one. Dont expect it to last a life time but for a decent amount of time. As for the loudness you could turn on the dishwasher to drown it out. Please try again later. Please try again later. GL 2.0 out of 5 stars I bought mine from Costco. What prompted me to write this review was not the loud noise of the unit

but the horrible food processor that is included.http://ghefoot.com/fckeditor_userfiles/how-to-manual-defrost-chest-freezer.xml



IMPORTANT SAFEGUARDS

When using electrical appliances, basic safety precautions should always be followed including the following:

1. READ ALL INSTRUCTIONS, PRODUCT LABELS AND WARNINGS BEFORE USING THIS BREAD MAKER.

2. Do not touch hot surfaces; carry the unit by handles. Always use oven mitts when handling hot material, and allow metal parts to cool before cleaning. Allow the bread maker to cool thoroughly before putting in or taking off parts.
3. When unit is not in use and before cleaning, unplug the bread maker from wall outlet. Let the bread maker cool down thoroughly before assembling or disassembling it.
4. To protect against risk of electrical shock, do not immerse the appliance or plugs in water or other liquids.
5. Close supervision is always necessary when this or any appliance is used near children or incapacitated persons.
6. Do not allow anything to rest on the power cord. Do not plug in cord where people may walk or trip on it. Unplug this bread maker from the wall outlet before you go out for a trip or long excursion.
7. Do not operate this or any appliance with a frayed or damaged cord, or plug, or after the appliance malfunctions or is dropped or has been damaged in any manner. Take appliance to the nearest authorized service facility for examination, repair or electrical or mechanical adjustment.
8. Do not let the cord dangle over the edge of a table or counter or touch hot surfaces. Do not place on an unsteady or cloth-covered surface.
9. Avoid contact with moving parts.
10. Do not use attachments not recommended by the manufacturer. They may cause fire, electric shock or injury.
11. Do not use outdoors or for commercial purposes.

12. Do not place the appliance near a hot gas or electric burner, or in a heated oven.
13. Keep power cord away from the hot surface of this bread maker. Do not put any flammable object on the hot surface of this bread maker.
14. Place this bread maker a minimum of 2 inches away from wall or any other object.
15. Do not use this bread maker for other than its intended use.
16. When plugging or unplugging this bread maker, be sure not to touch the plug blades with your fingers.
17. To unplug, press and hold the Stop/Pause button for 1-3 seconds, grip plug and pull from wall outlet. Never pull on the cord.
18. Use of extension cords: A short power supply cord has been provided to reduce the risk of injury resulting from becoming entangled in or tripping over a longer cord. Extension cords are available from hardware stores and may be used with care. The cord should be arranged so that it will not drape over the counter or table top where it can be pulled by children or tripped over accidentally. If the appliance is of the grounded type, the extension cord should be grounded type 3-wire cord.
19. Electric power: If electric circuit is overloaded with other appliances, your bread maker may not operate properly. This bread maker should be operated on a separate electrical circuit from other operating appliances.

**THIS UNIT IS INTENDED FOR HOUSEHOLD USE ONLY
READ AND SAVE THESE INSTRUCTIONS**

Yes the blender is very loud and you may want to invest in some ear plugs when operating this machine but it did do the job when it came to making smoothies, which is what I was using it for. However, the food processor is a piece of junk and was unusable on the first try. The plastic area of rotation where the blade spins from broke into small pieces when the unit turned on and got into the sauce I was making which had to be thrown out. I tried taking the unit apart to clean but the blade and bowl were stuck to the base and couldnt be removed until I was able to pry it off with a large screwdriver. I contacted Cusinart through email for a replacement but so far have received no response. Please try again later. Please try again later. Please try again later. Please try again later. Lauren Riggs 1.0 out of 5 stars What a joke. Stay away from this cheaply made product, as all of these negative reviews attest. Please try again later. Please try again later. Gail 1.0 out of 5 stars I have only used it about 3 times. I used it to make smoothies. The Third time I used it. The Smoothie was leaking out all over the counter and I turned it off only to realize that the Base I think it is the collar assembly was cracked and broken. So now the blender is completely unusable. I am looking for the part for this model and it is not available the collars on the parts website are for different models. Dont Buy this Blender!!!! I havent even tried the food processor yet. Please try again later. Please try again later. N. Claussen 2.0 out of 5 stars The blender and small food processor seem to work fine. The blender, however, leaks from the bottom of the blender jar every time we have tried to make a smoothie or milkshake. It makes quite a mess in the blender base as well as on the kitchen counter. Disappointing since this is the main use of a blender in our home. The rubber ring seems fine. I will be contacting Cuisinart about this problem. Please try again later.

Please try again later. Kevin 1.0 out of 5 stars It quit turning on. The design of the model requires you to press an on switch and then select the power setting. The unit began turning off in the middle of blending. Then it quit turning on all together. I was blending fruit smoothies. Its not an issue of overloading the unit. The unit blended ok when it worked, however the pitcher design does not pour

well. The pitcher is square on top and the spout is on a straight edge, instead of the corner. It leaves a heavy trail down the outside of the pitcher every time you pour. The fluid stream comes out wider than the glass you are pouring into. Please try again later. Please try again later. Amazon Customer 4.0 out of 5 stars I have been using it at least weekly for 8 years. It is so powerful, I have ground wheat with it and it completely purees solidly frozen strawberries. I agree that it is loud and the pour spout is not great which is why it got 4 stars instead of 5. Please try again later. Please try again later. Nadine 1.0 out of 5 stars I received it for Christmas and was stoked to make my own soups, salsas, shakes. etc. Ive used it a total of 4 times and the handle has already cracked, the blade in the processor has gotten stuck twice, and yes. it is loud. Im more annoyed with the blade getting stuck. My food processor is out of commission and its upsetting. Please try again later. Please try again later. Even though parts may look the same, there are often variances in similar parts and it is important to buy parts that fit your specific model. Please try again. Select the series that matches your model number. Try checking the product description for more information. Our payment security system encrypts your information during transmission. We don't share your credit card details with thirdparty sellers, and we don't sell your information to others. Please try again. Please try again. This product does not include any warranty from the manufacturer.

FEATURES AND BENEFITS

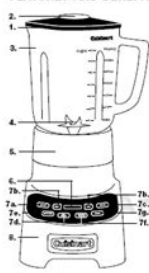

1. **Cover and Leak-Proof Rubber Gasket**
Just press on. Tightening seal secures lid. Rubber gasket holds lid snugly in position for safe operation.
2. **Measured Pour Lid**
Allows you to measure and add ingredients without removing the cover.
3. **56-oz. Glass Jar**
Has a unique, sturdy, easy to pour design.
4. **High-Quality Cutting Assembly with Power Turbo-Edge® Stainless Steel Blade**
Is strong enough for all blending tasks, including tough jobs, from ice crushing to chopping delicate herbs.
5. **Locking Ring/Collar**
Is self-aligning so that the glass blender jar slides easily into position.
6. **Pre-Programmed Ice Crush Button**
Press Ice Crush and begin crushing. This button is pre-programmed using the best combination of speed and timed pulsing for crushing ice without over-processing.
7. **Pre-Programmed Smoothie Button**
The perfect combination of speed and power timed to develop results in under 30 seconds!
8. **Soups & Sauces Button**
Pre-set speed blends a variety of ingredients, hot or cold, into your favorite soups, sauces, or dressings.
9. **Puree Button**
High speed pre-set breaks down foods to pure, velvety consistencies.
10. **Heavy-Duty Die Cast Metal Motor Base**
Is so sturdy and stable with a low center of gravity, it will not "walk" on your counter.
11. **Slip-Proof Feet (not shown)**
Prevent movement during use and prevent damaging marks on countertop or tables.
12. **Cord Storage (not shown)**
Keeps countertop safe and neat by conveniently storing excess cord.

USE AND CARE

ASSEMBLY

To use your Cuisinart® PowerEdge™ 700-Watt Blender, begin by assembling the blender jar:

1. Turn the blender jar (a) upside down, and place it flat on a sturdy surface.
2. Position the rubber gasket (b) on the round opening on the bottom of the blender jar.
3. Turn the cutting assembly (c) upside down, and place the blade and in the blender jar opening.

Note: Blades are sharp... handle carefully.

This blade should be handwashed after use. Register a free business account Full content visible, double tap to read brief content. Please try your search again later. Fabricated from sturdy stainless steel, its great to have as a spare or replacement piece. This blender blade and included gasket fit most Cuisinart brand blenders, and are durable and long lasting. Please be advised that gasket color may vary between gray and clear depending on availability. BlendWiz and its affiliates have no affiliation with the Cuisinart brand or its affiliates expressed or implied. This is an aftermarket part fabricated to fit and work with your blender. To calculate the overall star rating and percentage breakdown by star, we don't use a simple average. It also analyzes reviews to verify trustworthiness. Please try again later. CaliCo 1.0 out of 5 stars I used it maybe three times for light duty blending were taking banana smoothie. I didnt know what was happening but smelled something burning. It turned out parts of the plastic beneath the blade cracked and flew off into my smoothie, causing it to leak out all over, and damage the motor. Fortunately, I realized before I served it to my son. It was a mess and a waste of money! We must have consumed the huge chinch of plastic and hope its already left our bodies. I didnt know till after. Very dangerous. I was going to throw the whole blender away when my husband inspected the blade and noticed the plastic was just cracked and suggested I check Amazon for a replacement. Lo and behold, here it is. Received quickly and works great. The rubber stopper is a little more flimsy than the original, but works just fine. Its good to know it can be replaced, though hopefully I wont need to for a while. The original was so sharp you had to be careful when washing it. This one is dull, no edge at all. I would never order from

them again. The only thing that makes it work is the powerful blender. Misleading.

<http://nanyangco.com/images/conmed-system-7550-manual.pdf>

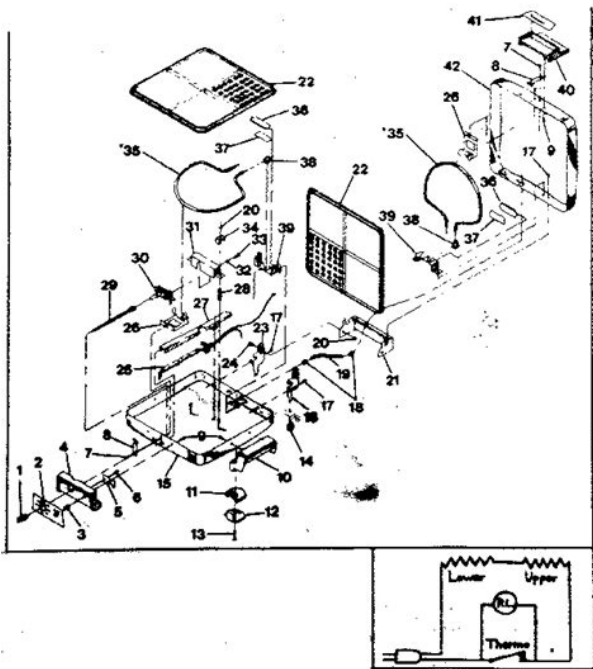

Its seems durableHow do i get a refund or get a new oneThe blade hasn't even been sharpened. Don't waste your time or money on this. Spend the money and get the name brand replacement not this terrible knock off. Sorry, we failed to record your vote. Please try again Amazon guided me through the search for parts, delivery was quick and smoothies are back on the menu. Sorry, we failed to record your vote. Please try again Sorry, we failed to record your vote. Please try again Blender leaks badlySorry, we failed to record your vote. Please try again In order to navigate out of this carousel please use your heading shortcut key to navigate to the next or previous heading. We delete comments that violate our policy, which we encourage you to read. Discussion threads can be closed at any time at our discretion. By continuing to use our website, you agree to our updated Terms of Use and Privacy Policy. We appreciated your patience, we are doing our best to ship your orders on time. Please turn it on so that you can experience the full capabilities of this site. We appreciated your patience, we are doing our best to ship your orders on time. If you are unable to locate the part or accessory, contact our Support Team at 18004727606 MONFRI 900 am to 430 pm EST or email Service Centre You may withdraw your consent to receive emails at any time. Please email us if youre running the latest version of your browser and you still see this message. The actual Open Box product may differ in packaging and included accessories, but has been tested to ensure basic functionality. Click here for more details. Secure shopping made faster. Check out with PayPal. Some manufacturers place restrictions on how details of their products may be communicated. Some manufacturers place restrictions on how details of their products may be communicated. Some manufacturers place restrictions on how details of their products may be communicated.

<https://omann.com/images/conmed-system-7500-user-manual.pdf>

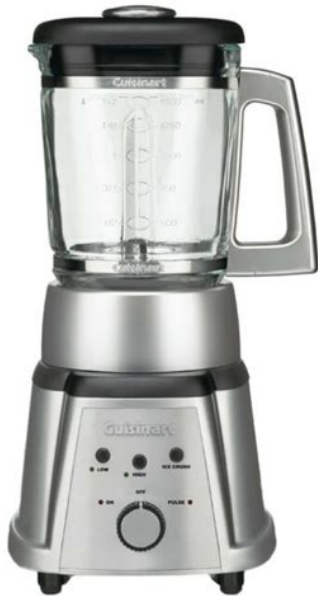

Some manufacturers place restrictions on how details of their products may be communicated. Por favor, intentalo de nuevo mas tarde. Para navegar fuera de este carrusel, usa tu tecla de acceso rapido de encabezados para navegar hacia el encabezado siguiente o anterior. Full content visible, double tap to read brief content. Intenta realizar tu busqueda nuevamente mas tarde. De todos modos, podra editar su pregunta o publicacion. Para calcular la calificacion general por estrellas y el desglose porcentual por estrellas, no usamos un promedio simple. Nuestro sistema toma en cuenta cosas como lo reciente que es una calificacion y si el revisor compro el producto en Amazon. Tambien analiza las calificaciones para verificar su fiabilidad. Tags user s630 manual samsung. FunctionProducts 1 50 of 105 Cuisinart Blender manuals and owner instruction guides. To keep your account secure, use this option only on your personal devices Any occasion, any time. Thoroughly Tested. Made with Care. If these instructions do not match your product, or you are unable to find the information you need, please call customer service at 1.877.812.6235. Assembly instructions are in pdf format. You can download the Acrobat Reader on Adobes website. Temp Gooseneck Glass Kettle 264867 Manual Temp Gooseneck Glass Kettle 264867 Manual. For your safety and continued enjoyment of this product. Page 2 Page 3 IMPORTANT 17. Important Safeguards..... 2. Page 5 GETTING TO KNOW YOUR CONTROL PANEL Page 7 COOKING GUIDELINES Steaming is one of the healthiest methods of cooking. No butter or oil is required and Page 11 Troubleshooting Chart Page 12 WARRANTY BEFORE RETURNING YOUR CUISINART Page 13 NOTES Mix in vanilla and sour cream. Be. Page 15 Dulce de Leche Dulce de Leche Bread Page 16 Dense Chocolate Cake Traditional Rice Pudding Page 17 medium speed until smooth Add the cream Page 18 Desserts Serve over rice. 5. Return the browned chicken to the.

Page 23 Corned Beef with Brisket of Beef Takes a couple of days. Page 24 Paella. This version of the traditional Spanish dish is 4. Put the tomatoes into the cooking pot Page 28 Green Chile Tamales Page 29 Fresh Herb Chicken with Chicken with Three Peppers Let juice come to. Page 31 Moroccan Lamb Stew Caldo Verde Not exactly a purist's. Page 33 Super Chili Spinach Dal Page 34 Mushroom Barley Soup Beef Stew Page 36 Garden Vegetable Sauce Bolognese Page 40 Sausage Bites in Pork Dumplings Page 42 RECIPES. Up to 3 times YMMV With 20GB Data PC Express first time user. Redeem with Raptors app Niagara Falls service resumes Aug 1st Maybe for new members too.

<https://discoveryenglish.org/wp-content/plugins/formcraft/file-upload/server/content/files/162886fe4ae60e---Can-t-manually-put-music-on-iphone.pdf>

www.cnlpzz.com/d/files/canon-ipf8100-user-manual.pdf